



# NEWFIELDS



## **Bret Waller Gallery** Indianapolis Museum of Art at Newfields Arakawa Hanging System User Guide

### **General**

The Bret Waller Gallery at the Indianapolis Museum of Art at Newfields utilizes an Arakawa Hanging System for the exhibition of two-dimensional artwork.

### **Waller Gallery Arakawa Hanging System**

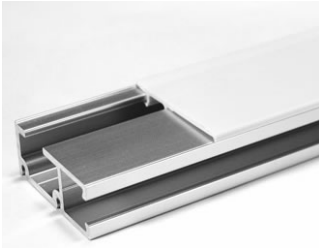
The Bret Waller Gallery's Arakawa Hanging System utilizes the following parts:

<p><b>Rails</b> The rails are mounted to the ceiling.</p> 	<p><b>Cable</b> Waller Gallery uses 1/16" cable that attaches to the rails. Cables can be repositioned along the rails and can also be doubled to provide a double hang (one artwork hung vertically over another).</p> 	<p><b>Grippers</b> The grippers attach to the cable and are adjustable vertically. The artwork hangs from the grippers by the strap hangers or d-rings.</p> 
---	---	--

## Preparing your artwork for Waller Gallery

For successful artwork installation using the Arakawa Hanging System:

- Strap hangers or d-ring hanging hardware are required for all two-dimensional artworks. Artwork will not be able to be hung by wire or by sawtooth hangers.



- For metal frames, please use Euro hangers with wire loops approximately 1" long. The top of the wire loop should be 3" from the top edge of the frame.

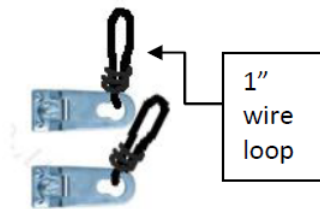

- Strap hangers and d-rings should be attached in parallel with the frame or painting stretcher/strainer.

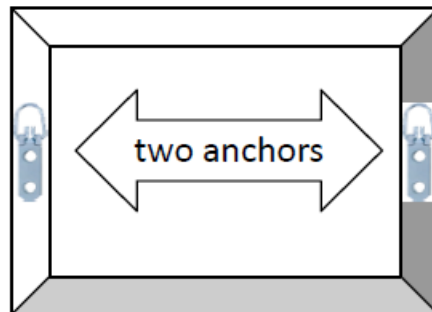
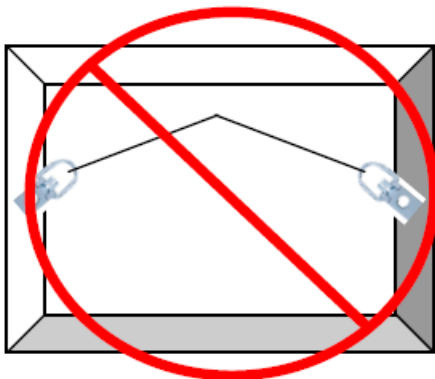



## NEWFIELDS

- 
- The top of the strap hangers or d-rings should be approximately 3 inches from the top edge of the Artwork. This distance will hide the hanging hardware, while allowing your artwork to hang flat against the wall and prevent the artwork from tilting forward.

